



Product Applications

DCS-1



Terminal System Overview



Housing Overview

9.5 mm female and male terminals

Features

- DCS-1 technology
- 12.0 mm pitch for unsealed applications
- 12.5 mm pitch for sealed application with single wire seal
- Auxiliary steel spring in CrNi
- High current carrying capacity (up to 75 A at +23° C)
- Protected contact springs
- Compatible with single wire sealing
- Silver-plated versions possible

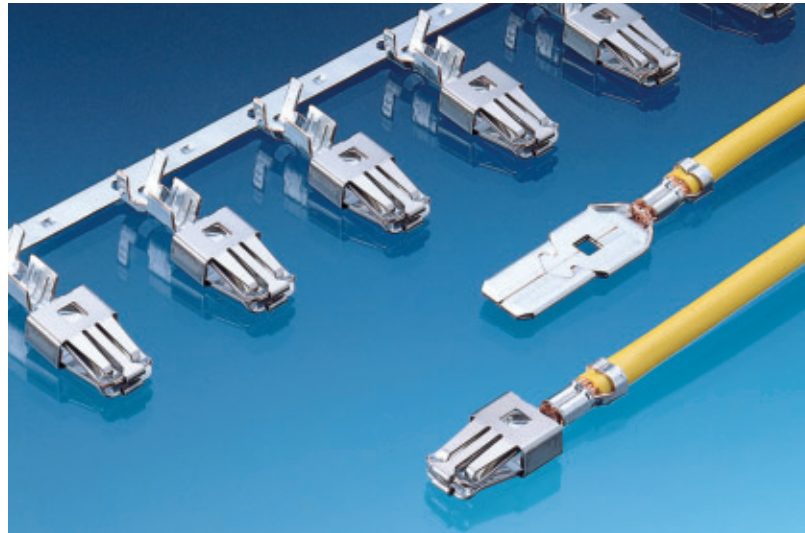

Performance characteristics*

- Contact resistance: < 3 mΩ
- Contact mating force: < 21 N
- Contact unmating force: < 15 N
- Current carrying capacity with 10 mm² wire:
 - at 23° C up to approx.: 75 A
 - at 85° C up to approx.: 50 A
 - at 100° C up to approx.: 40 A

*Mated with 9.5 x 1.2 mm DCS-1 male terminal (Sn)

Packing

- No. of terminals per reel: Consult us
- No. of reels per packing: Consult us

Tooling

- Hand crimping tools
- Automatic crimping tools

[Click here to see DCS housings](#)

Part Numbers	Type	Wire size range (in mm ²)		Insulation Ø (in mm)	Material	Plating or Color
		Min.	Max.	Max.		
6 007 02 51	Female	2.50	4.00	3.70 (FLRY wire)	CuCrSiTi/CrNi	Sn
6 007 02 61	Female	> 4.00	6.00	4.30 (FLRY wire)	CuCrSiTi/CrNi	Sn
6 007 02 71	Female	> 6.00	10.00	6.40 (FLRY wire)	CuCrSiTi/CrNi	Sn
6 017 02 51	Male	2.50	4.00	3.70 (FLRY wire)	CuSn	Sn
6 017 02 61	Male	> 4.00	6.00	4.30 (FLRY wire)	CuSn	Sn
6 017 02 71	Male	> 6.00	10.00	6.40 (FLRY wire)	CuSn	Sn
6 099 33 01	SWS	2.50	6.00	3.50 - 5.20		Black
6 099 33 03	SWS	> 4.00	6.00	6.20 - 6.60		Red
6 099 33 06	Blind plug					White





Product Applications

DCS-1



Terminal System Overview

9.5 mm female and male terminals

Dimensional characteristics

Notes :

Female terminals

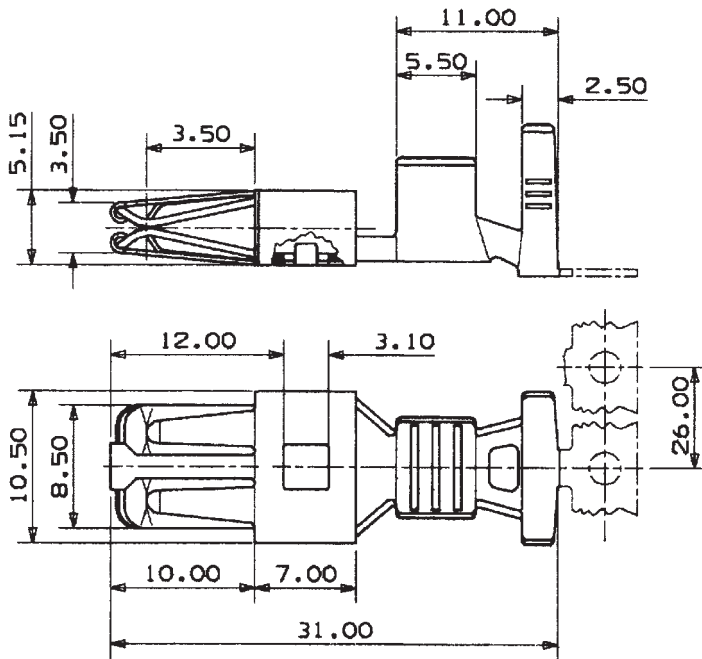

Male terminals

